

ROLEX ET L'ARCHITECTURE

VISUELS

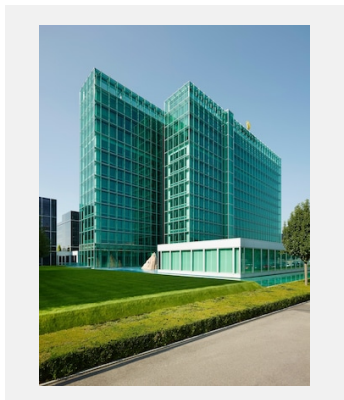

Réf.: 1_aca_ha_ec1132-11_2_r

ROLEX - WORLD HEADQUARTERS,
ACACIAS, GENEVA

Crédits photo: © Rolex/Cédric Widmer

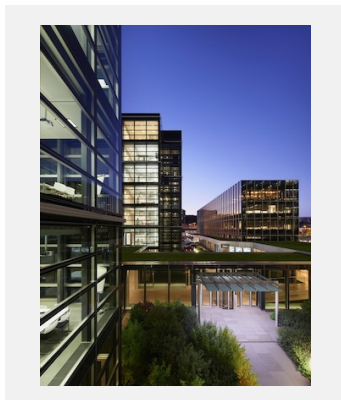

Réf.: 2_aca_ha_ec1132-07_r

ROLEX - WORLD HEADQUARTERS,
ACACIAS, GENEVA

Crédits photo: © Rolex/Cédric Widmer

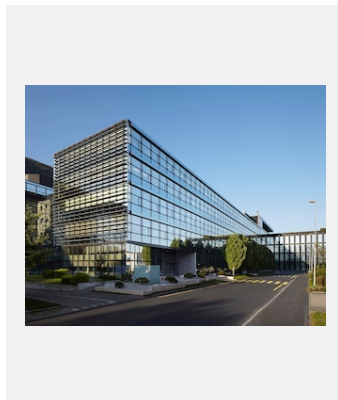

Réf.: 3_bie13cw-042_r

ROLEX - BIENNE

Crédits photo: © Rolex/Cédric Widmer

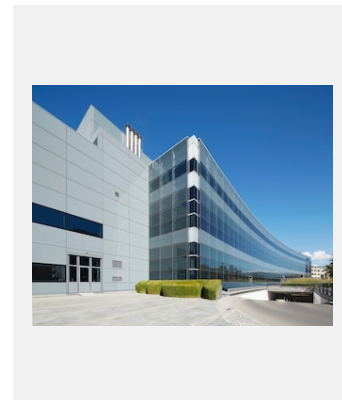

Réf.: 4_che13cw-14_r

ROLEX - CHÊNE-BOURG, GENEVA

Crédits photo: © Rolex/Cédric Widmer



Réf.: 5_plo_13cw-022_r

ROLEX - PLAN-LES-OUATES,
GENEVA

Crédits photo: © Rolex/Cédric Widmer

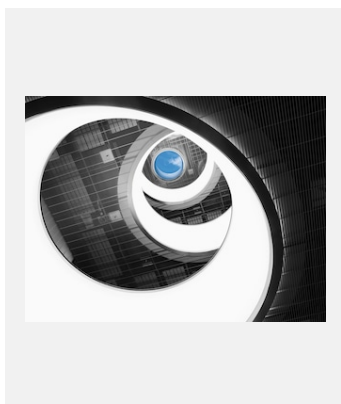

Réf.: 6_bie_12rl_071_r

ROLEX - BIENNE

Crédits photo: © Rolex/Rémy
Lidereau

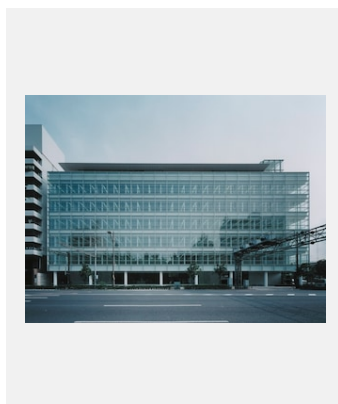

Réf.: 7northshiharukitajimar

ROLEX TOYOCHO BUILDING.
TOKYO, JAPAN

Crédits photo: © Rolex/©Toshiharu
Kitajima

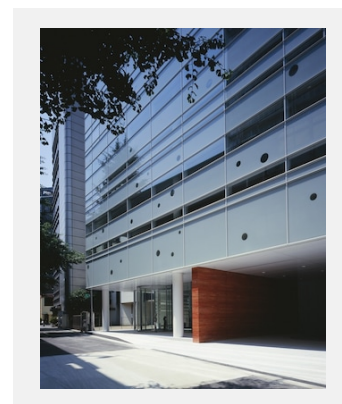

Réf.: 8rolexnakatsubuildingtoshiharukitajimar

ROLEX NAKATSU BUILDING.
OSAKA, JAPAN

Crédits photo: © Rolex/©Toshiharu
Kitajima

Planche-contact

ROLEX ET L'ARCHITECTURE

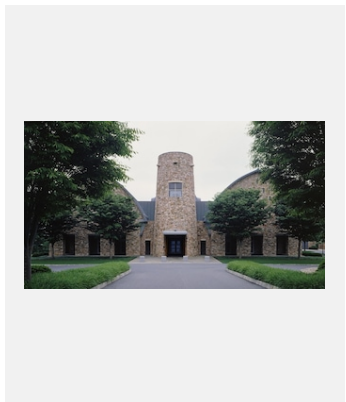

Réf.: 9_yanai-lititz4

LITITZ WATCH TECHNICUM. US

Crédits photo: © Rolex/©Yanai Toister

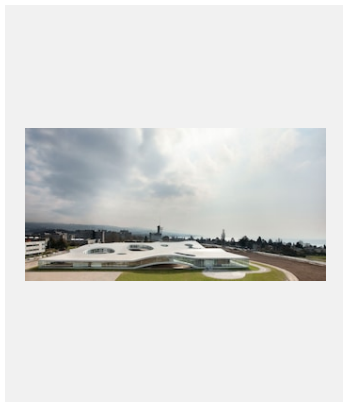

Réf.: 10_rlc_13_04_2010-679_r

ROLEX LEARNING CENTER,
ÉCOLE POLYTECHNIQUE
FÉDÉRALE DE LAUSANNE.
SWITZERLAND

Crédits photo: © Rolex/©Julien Lanoo

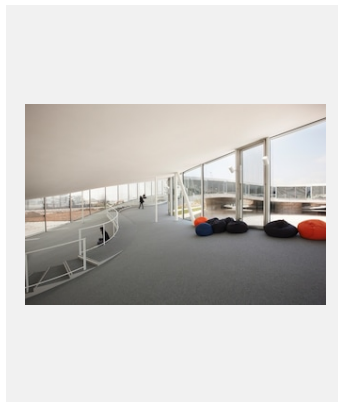

Réf.: 11_rlc_13_04_2010-980_r

ROLEX LEARNING CENTER,
ÉCOLE POLYTECHNIQUE
FÉDÉRALE DE LAUSANNE.
SWITZERLAND

Crédits photo: © Rolex/©Julien Lanoo

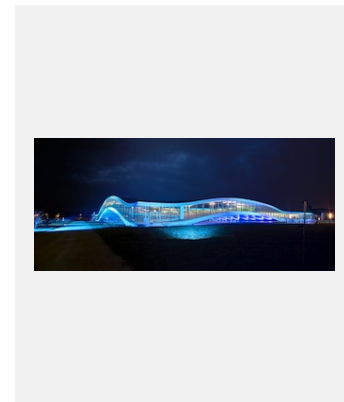

Réf.: 12_rlc-epfl_13jh_010_r

ROLEX LEARNING CENTER,
ÉCOLE POLYTECHNIQUE
FÉDÉRALE DE LAUSANNE.
SWITZERLAND

Crédits photo: © Rolex/Jess Hoffman

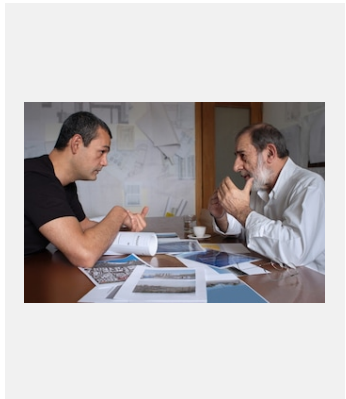

Réf.: 13_rmp1va_5769_r

SAHEL AL-HIYARI, PROTÉGÉ, AND
ÁLVARO SIZA, MENTOR. PORTO,
PORTUGAL, 2003

Crédits photo: © Rolex/Tomas
Bertelsen

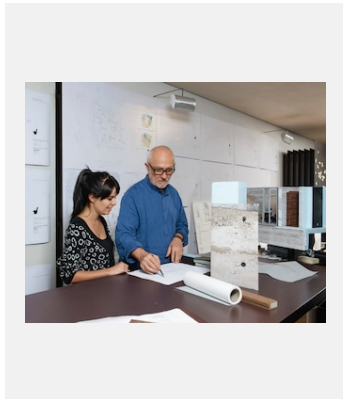

Réf.: 14_rmp7a_f096_r

PETER ZUMTHOR, MENTOR AND
GLORIA CABRAL, PROTÉGÉE.
HALDENSTEIN, SWITZERLAND,
2014

Crédits photo: © Rolex/Marc Latzel

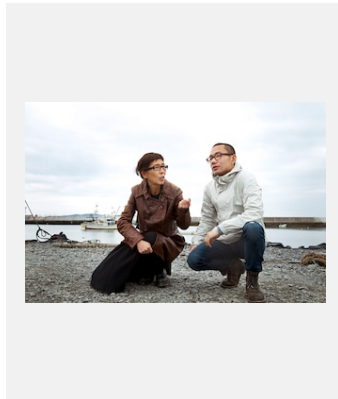

Réf.: 15_rmp6a1304_01-021_r

KAZUYO SEJIMA AND YANG ZHAO
VISIT THE SITE CHOSEN FOR A
HOME-FOR-ALL IN JAPAN. 2013

Crédits photo: © Rolex/Hideki
Shiozawa

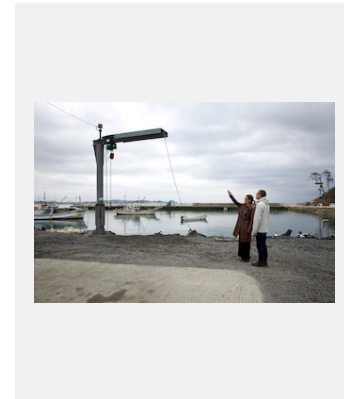

Réf.: 16_rmp6a1304_01-023_r

KAZUYO SEJIMA AND YANG ZHAO
VISIT THE SITE CHOSEN FOR A
HOME-FOR-ALL IN JAPAN. 2013

Crédits photo: © Rolex/Hideki
Shiozawa

Planche-contact

ROLEX ET L'ARCHITECTURE

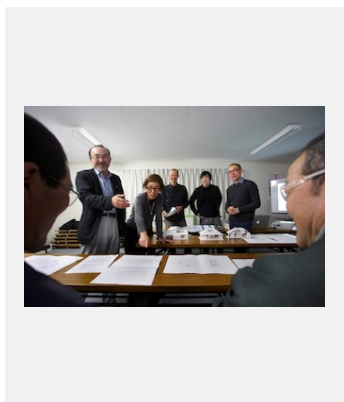

Réf.: 17_rmp6a1304_02-057_o_r

KAZUYO SEJIMA AND YANG ZHAO EXCHANGE IDEAS DURING A WORKSHOP. JAPAN, 2013

Crédits photo: © Rolex/Hideki Shiozawa

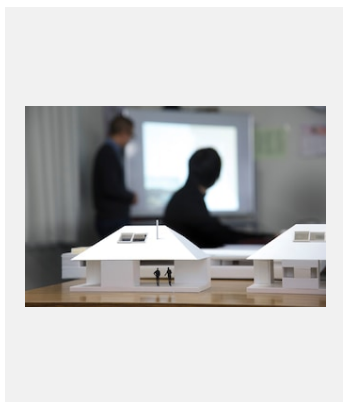

Réf.: 18_rmp6a1304_02-003_r

A MODEL OF THE HOME-FOR-ALL MADE BY YANG ZHAO AT THE WORKSHOP IN KESENNUMA. JAPAN, 2013

Crédits photo: © Rolex/Hideki Shiozawa

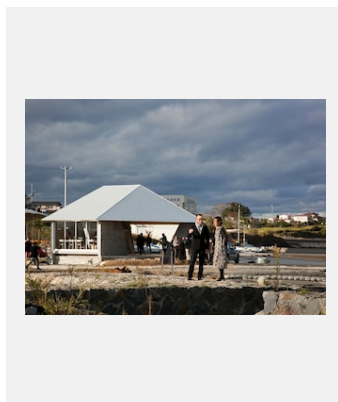

Réf.: 19_02_pair4_r

ARCHITECTURE MENTOR KAZUYO SEJIMA WITH PROTÉGÉ YANG ZHAO AT THE HOME-FOR-ALL IN JAPAN

Crédits photo: © Rolex/©Suzuki Hisao for Rolex

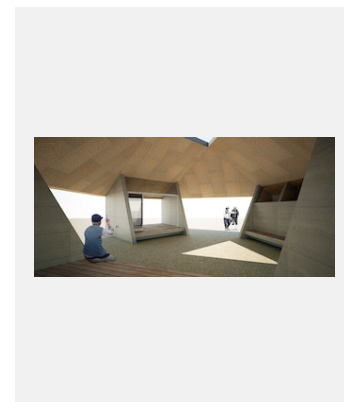

Réf.: 20_homeforall_interior_r

HOME-FOR-ALL, KESENNUMA, JAPAN

Crédits photo: © Rolex/©Yang Zhao

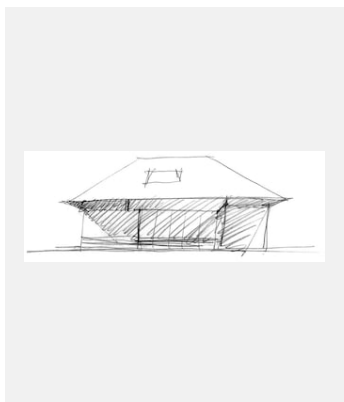

Réf.: 21_homeforall_r

SKETCH BY YANG ZHAO FOR THE HOME-FOR-ALL IN KESENNUMA, JAPAN

Crédits photo: © Rolex/©Yang Zhao

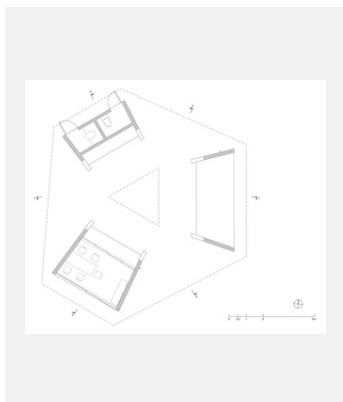

Réf.: 22_plan_r

PLAN BY YANG ZHAO FOR THE HOME-FOR-ALL IN KESENNUMA, JAPAN

Crédits photo: © Rolex/©Yang Zhao



Réf.: 23_section

PLAN BY YANG ZHAO FOR THE HOME-FOR-ALL IN KESENNUMA, JAPAN

Crédits photo: © Rolex/©Yang Zhao

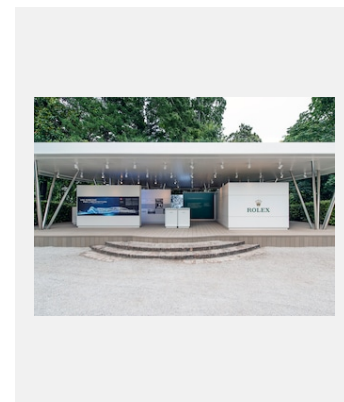

Réf.: 24_iae14ml_001

THE ROLEX PAVILION AT THE 14TH INTERNATIONAL ARCHITECTURE EXHIBITION LA BIENNALE DI VENEZIA

Crédits photo: © Rolex/Marc Latzel

Planche-contact

ROLEX ET L'ARCHITECTURE

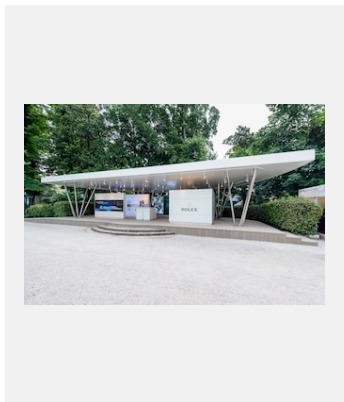

Réf.: 25_iae14ml_002

THE ROLEX PAVILION AT THE 14TH INTERNATIONAL ARCHITECTURE EXHIBITION LA BIENNALE DI VENEZIA

Crédits photo: © Rolex/Marc Latzel

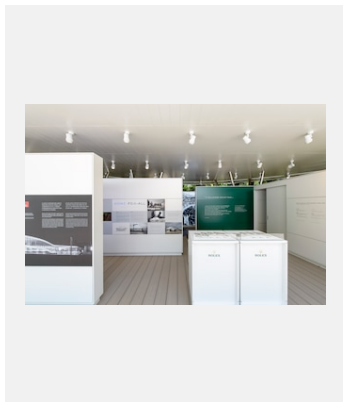

Réf.: 26_iae14ml_005

THE ROLEX PAVILION AT THE 14TH INTERNATIONAL ARCHITECTURE EXHIBITION LA BIENNALE DI VENEZIA

Crédits photo: © Rolex/Marc Latzel

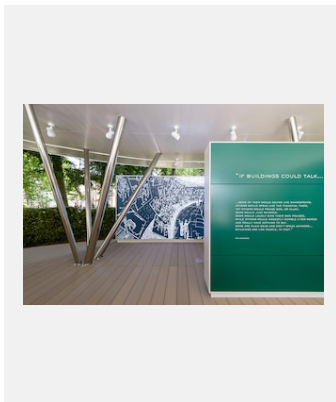

Réf.: 27_iae14ml_008r

THE ROLEX PAVILION AT THE 14TH INTERNATIONAL ARCHITECTURE EXHIBITION LA BIENNALE DI VENEZIA

Crédits photo: © Rolex/Marc Latzel

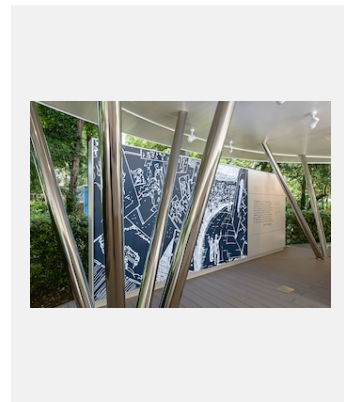

Réf.: 28_iae14ml_010r

THE ROLEX PAVILION AT THE 14TH INTERNATIONAL ARCHITECTURE EXHIBITION LA BIENNALE DI VENEZIA

Crédits photo: © Rolex/Marc Latzel



Réf.: 29_iae14_nh_ck-1001

GIANPAOLO MARINI, MANAGING DIRECTOR, ROLEX ITALY; REM KOOLHAAS, CURATOR OF THE 14TH INTERNATIONAL ARCHITECTURE EXHIBITION; REBECCA IRVIN, ASSOCIATE DIRECTOR, COMMUNICATION AND IMAGE, ROLEX SA; PAOLO BARATTA, PRESIDENT OF LA BIENNALE DI VENEZIA

Crédits photo: © Rolex/Nick Harvey

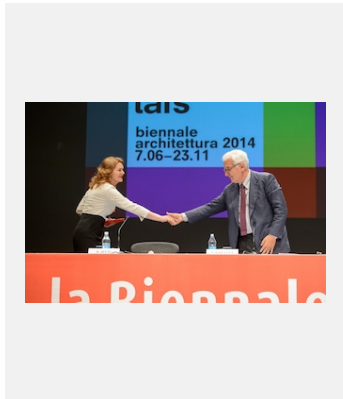

Réf.: 30_iae14_nh_pc-1001

REBECCA IRVIN, ASSOCIATE DIRECTOR, COMMUNICATION AND IMAGE, ROLEX SA WITH PAOLO BARATTA, PRESIDENT OF LA BIENNALE DI VENEZIA, DURING THE PRESS CONFERENCE

Crédits photo: © Rolex/Nick Harvey



Réf.: 31_iae14_nh_pc-1004

PRESS CONFERENCE FOR THE OPENING OF THE 14TH INTERNATIONAL ARCHITECTURE EXHIBITION - LA BIENNALE DI VENEZIA, SUPPORTED BY ROLEX

Crédits photo: © Rolex/Nick Harvey